



IMPORTED BY C&T International, Inc. / IMPORTE` PAR de C&T International, Inc.
105 Stonehurst Ct Northvale, NJ 07647 U.S.A. Tel, 201- 531-1919 Fax, 201- 531-1920

CANADA ADDRESS:

3453, DU PRESIDENT KENNEDY LAC MEGANTIC, QUEBEC, CANADA G6B 2Y4

Website: www.sorellefurniture.com / Site Internet : www.sorellefurniture.com

READ ALL INSTRUCTIONS BEFORE ASSEMBLING AND USE OF BED

FOR FUTURE USE AND REFERENCE RETAIN THESE INSTRUCTION SHEETS AND BED ASSEMBLY TOOLS IN THE ORIGINAL SACK AND SECURE THEM TO A SAFE PLACE

MODEL 215 BED RAILS ASSEMBLY INSTRUCTIONS

Thank you for selecting a C&T product. To ensure the best performance from your bed, please read these instructions carefully.

Carefully remove and lay out all parts. Familiarize yourself with all diagrams. Hardware enclosed in the sack should correspond with hardware list. Be sure all are included and quantities are correct.

Assembly Instructions

Parts List

No	Qty	Description
A	1	Back Frame
B	1	Front Frame with Corner Posts
C	1	Bed Rail
D	1	Bed Rail
E	4	Rail
F	16	Screw

Model shown is example only
Styles may vary.

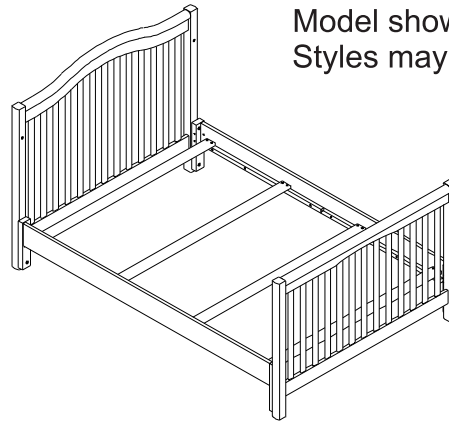

Junior Bed

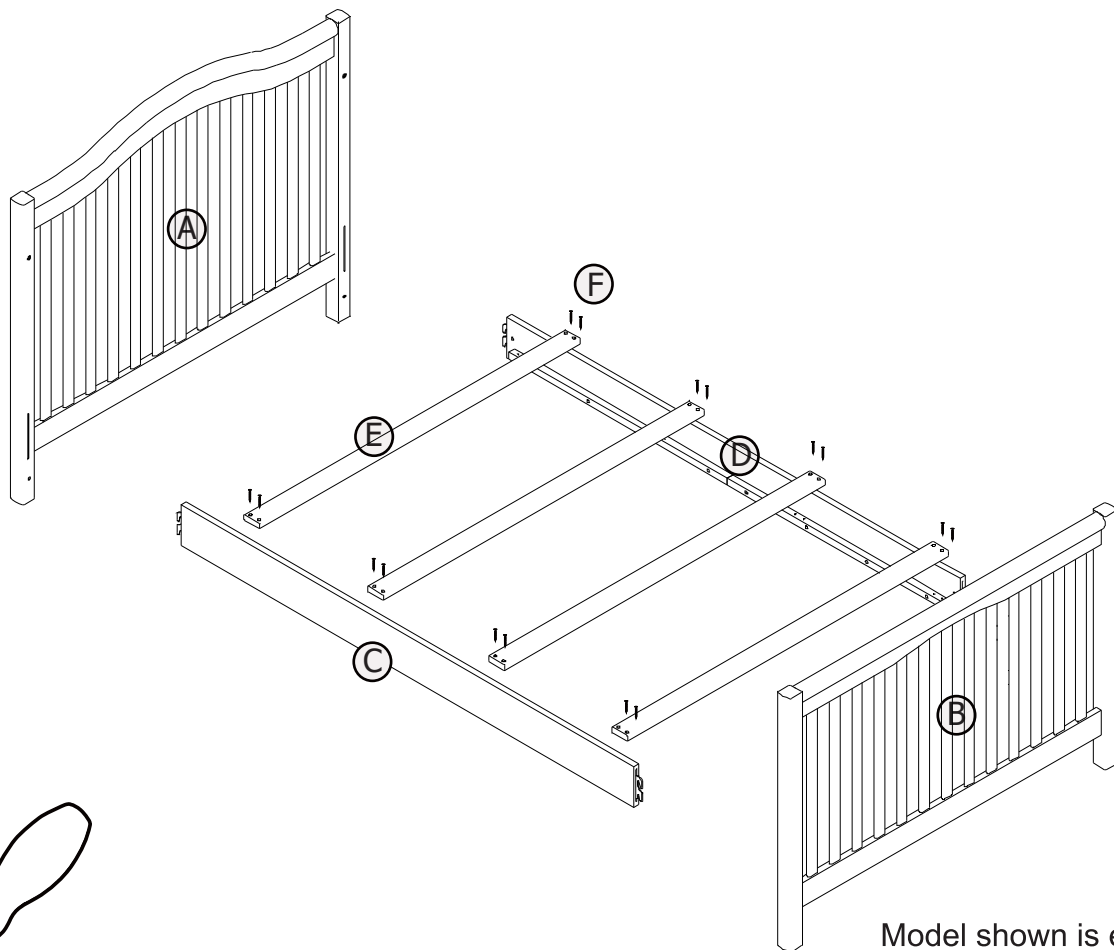

Model shown is example only
Styles may vary.

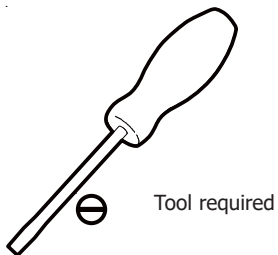

Tool required

Important: In order to properly assemble the bed, carry out the operations in order specified. Failure to assemble the bed in the manner recommended could make the bed hazardous.

Bed Assembly

1 Unassemble your crib and get the components, back frame (A) and front frame (B), then follow up below 2 steps.

2 Tighten all bolts and screws before using the bed

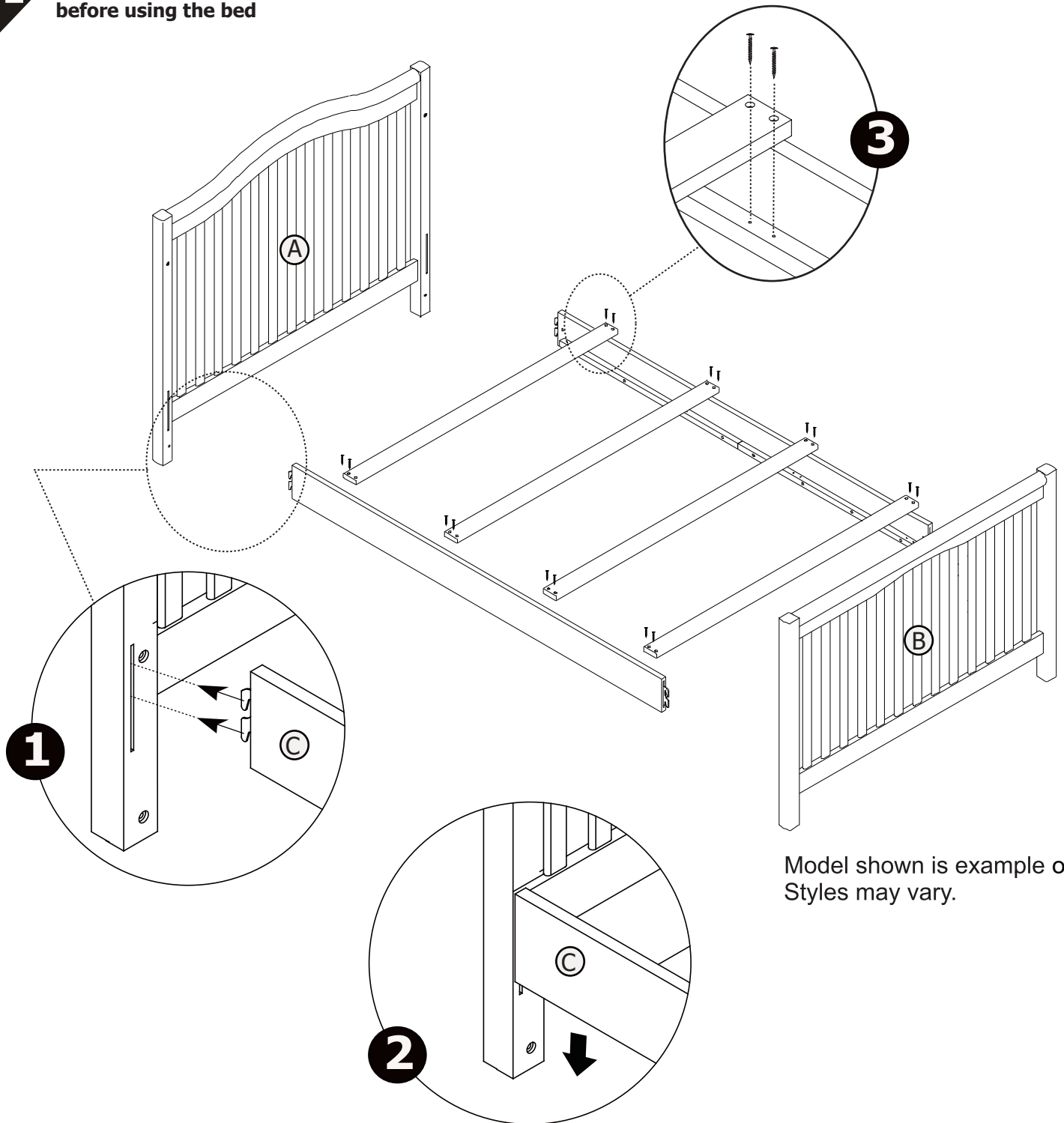

Model shown is example only
Styles may vary.