

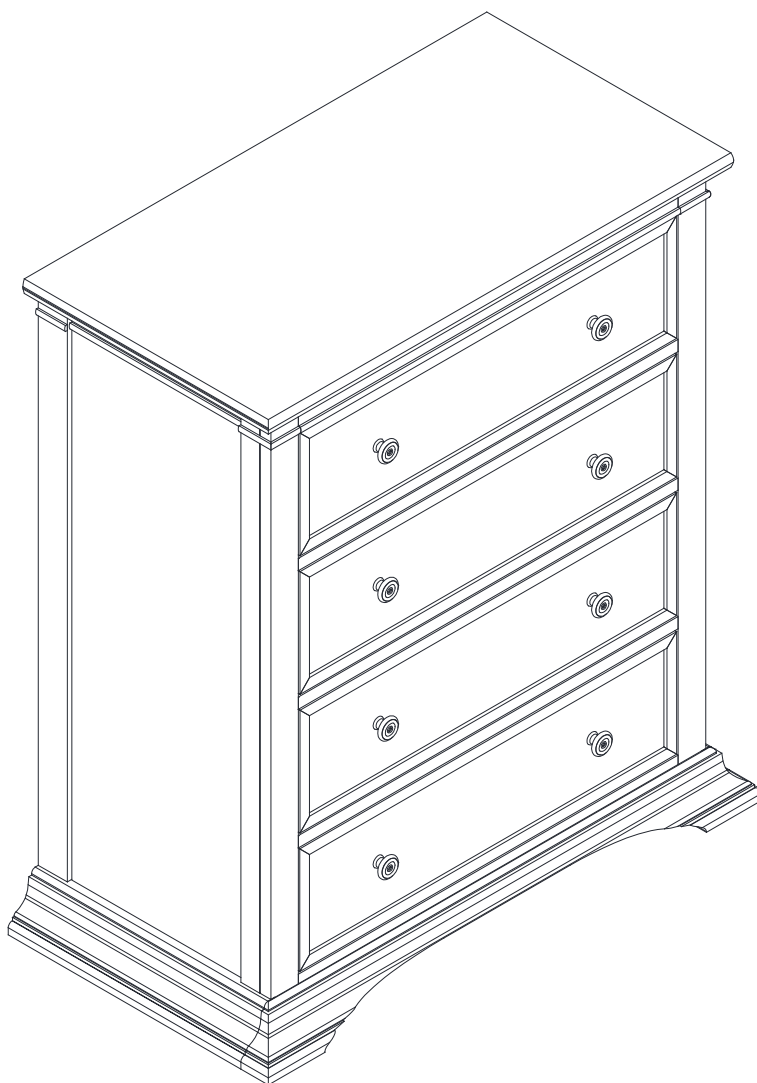

IMPORTED BY C&T International, Inc. / IMPORTE` PAR de C&T International, Inc.
105 Stonehurst Ct Northvale, NJ 07647 U.S.A. Tel, 201- 531-1919 Fax, 201- 531-1920
CANADA ADDRESS:
3453, DU PRESIDENT KENNEDY LAC MEGANTIC, QUEBEC, CANADA G6B 2Y4
Website: www.sorellefurniture.com / Site Internet : www.sorellefurniture.com

Emerson 4 Drawer Chest

Assembly Instruction



Important Information:

Read all instructions **BEFORE** assembling crib.
KEEP INSTRUCTIONS FOR FUTURE USE.

Assembly Parts

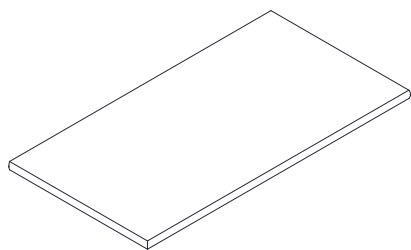

(A) Top Panel (x1)

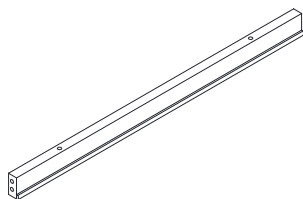

(B) Front Upper Rail (x1)

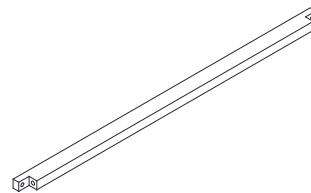

(C) Front Middle Rail (x3)

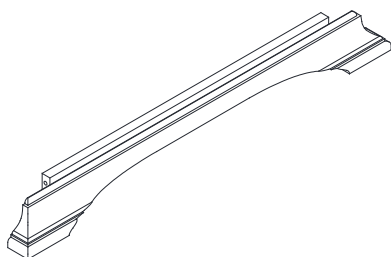

(D) Front Bottom (x1)

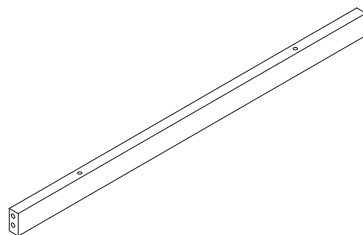

(E) Rear Upper Rail (x1)

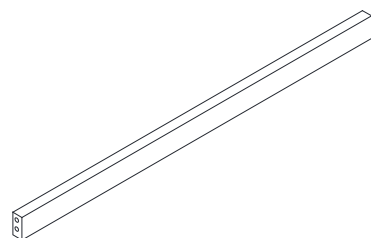

(F) Rear Middle Rail (x2)

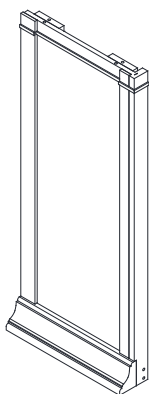

(G) Left Frame (x1)

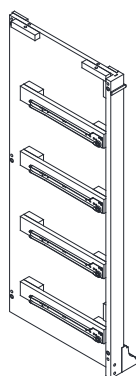

(H) Right Frame (x1)

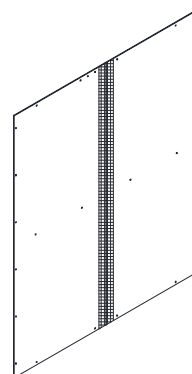

(I) Back Panel (x1)

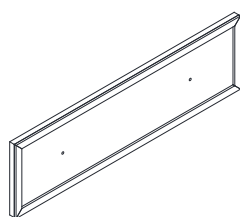

(R) Drawer Front (x4)

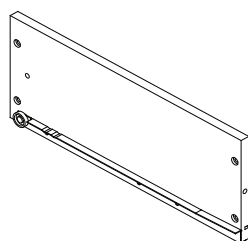

(R1) Drawer Left (x4)

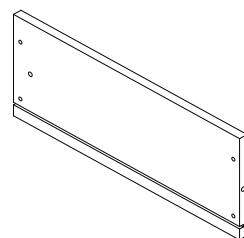

(R2) Drawer Right (x4)

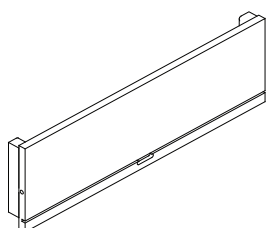

(R3) Drawer Back (x4)

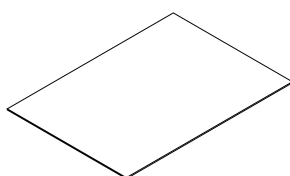

(R4) Drawer Bottom (x4)

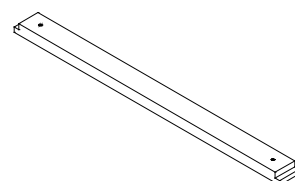

(R5) Drawer Support (x4)

Assembly Parts

Hardware list

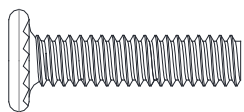

a (X6)
1/4" * 25

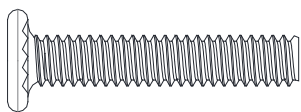

b (X8)
1/4" * 32

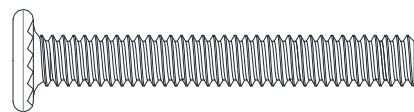

c (X14)
1/4" * 45

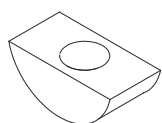

d (X10)
20 * 10 * 8

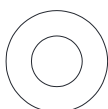

e (X18)
Φ 12 * 6 * 1.2



f (X28)
Φ 11 * 6 * 1.5

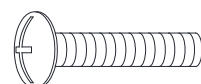

g (X8)
Φ 5/32 * 22

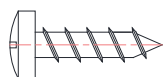

h (X24)
Φ 8 * 15

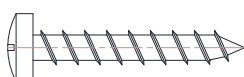

i (X32)
Φ 8 * 25



j (X12)
Φ 7 * 12

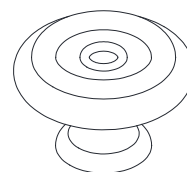

k (X8)

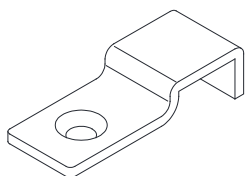

l (X4)
40 * 15 * 2

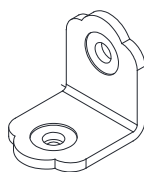

m (X4)
20 * 18 * 16



n (X20)
Φ 8 * 30

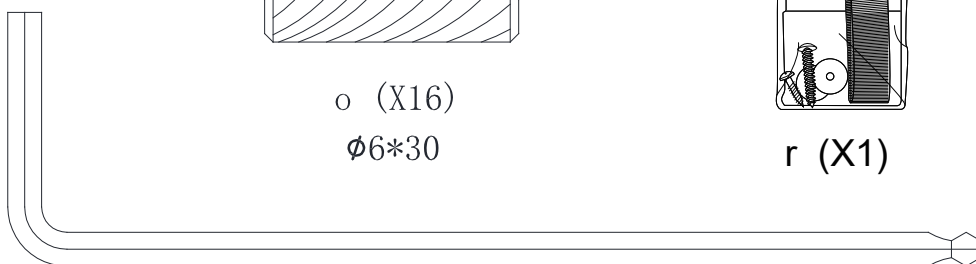

o (X16)
Φ 6 * 30

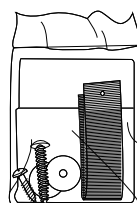

r (X1)

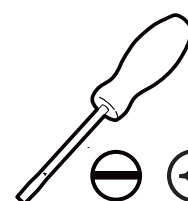

Tool required

p (X1)
M4x115

Assembly Steps

① Attach Rails to Right Panel (H) as Figure 1.

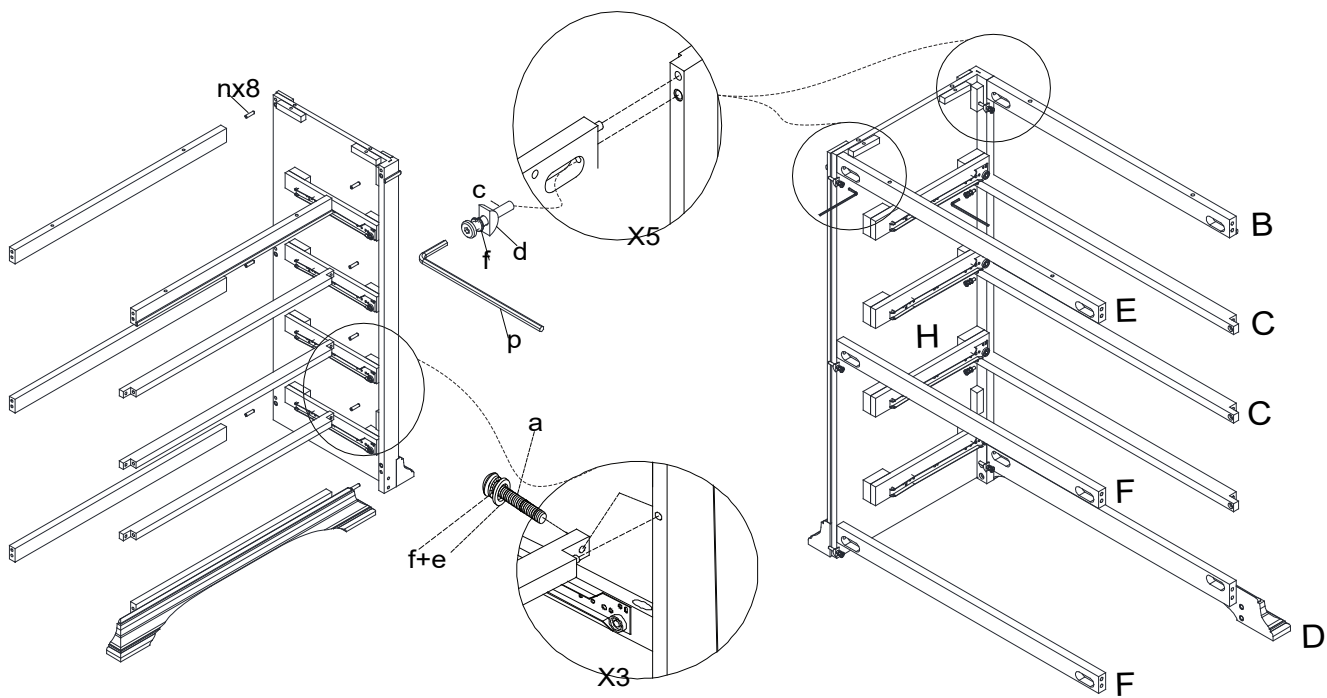

Figure 1

② Attach left side panel (G) to Rails as Fig.2

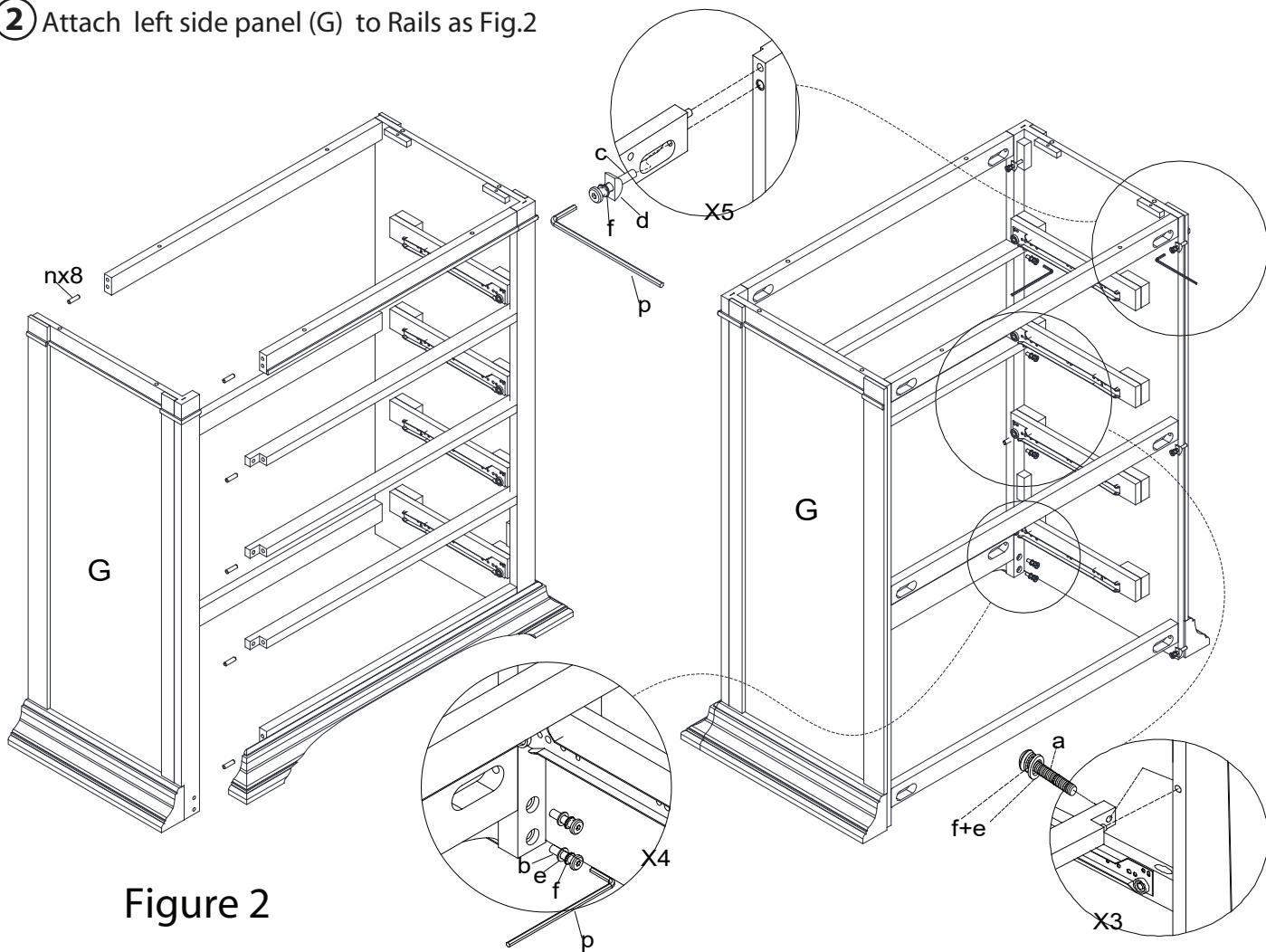

Figure 2

Assembly Steps

- ③ Attach Top Panel (A) to Side panels as Figure 3.

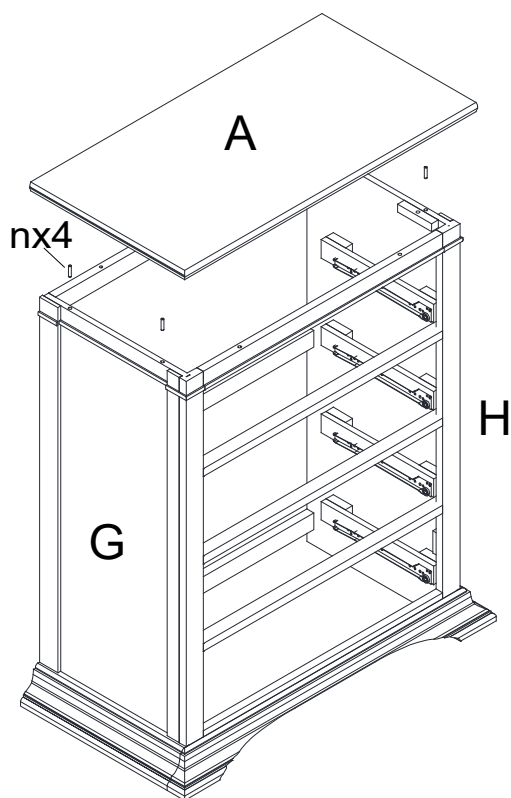

Figure 3

- ④ Attach Top Panel (A) to Side panels as Figure 4.

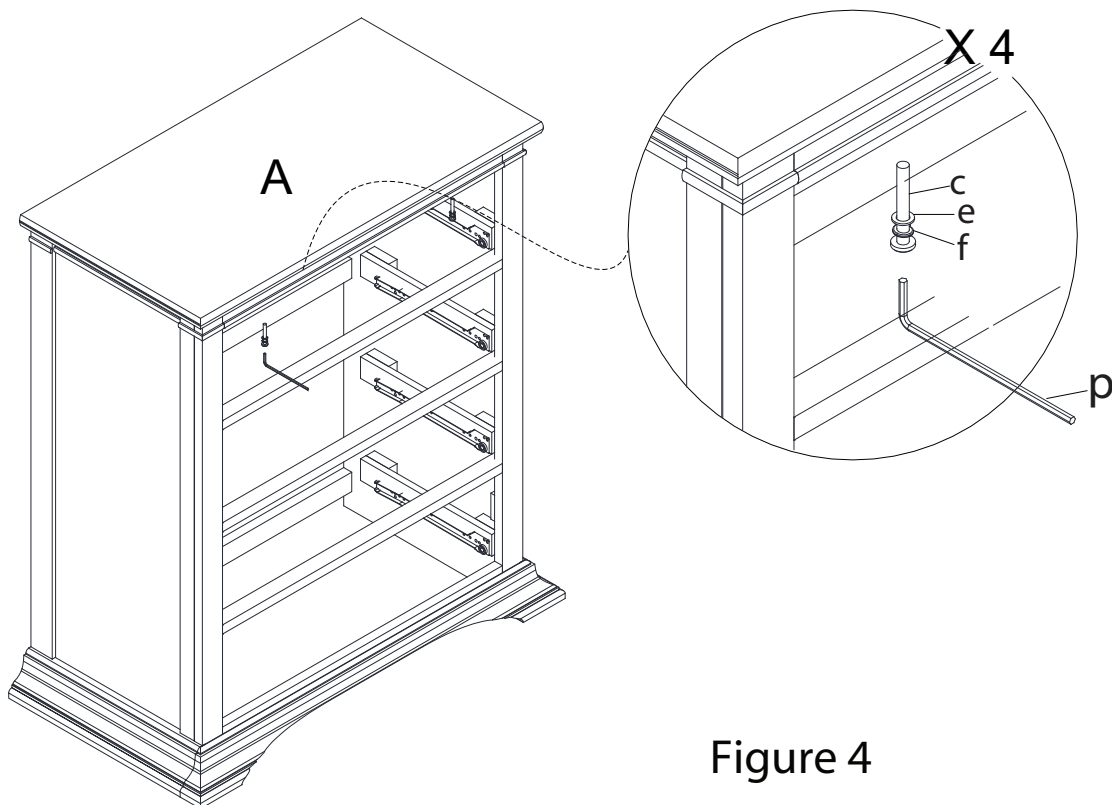
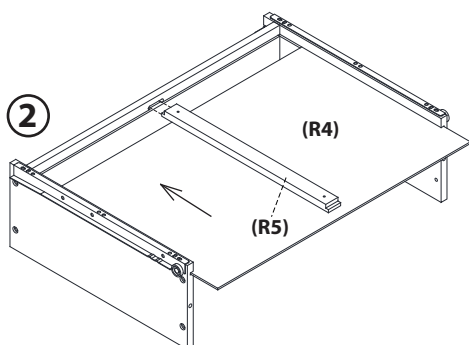
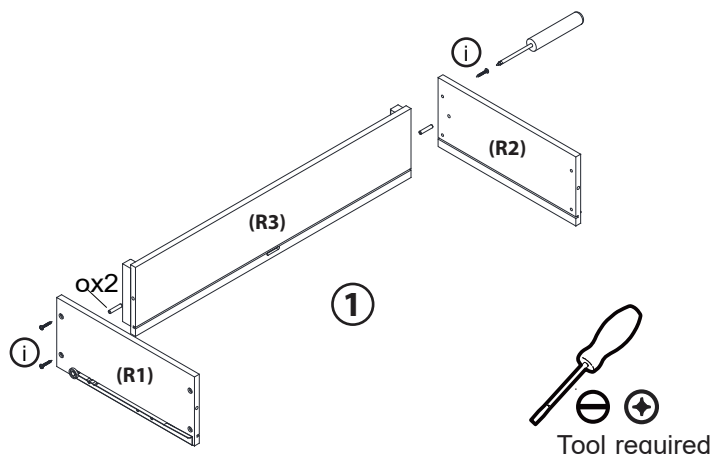

Figure 4

Drawer Assembly

1. Working on a padded flat surface, attach Drawer Sides (R1&R2) to Drawer Back (R3) with Philips Head Screw (i). *Figure 1*



2. Slide Drawer Bottom (R4) and into drawer Bottom Support (R5) assembly. *Figure 2*

3. Secure both sides of Drawer Front (R) to drawer assembly with four (4) Screws (i). *Figure 3.*

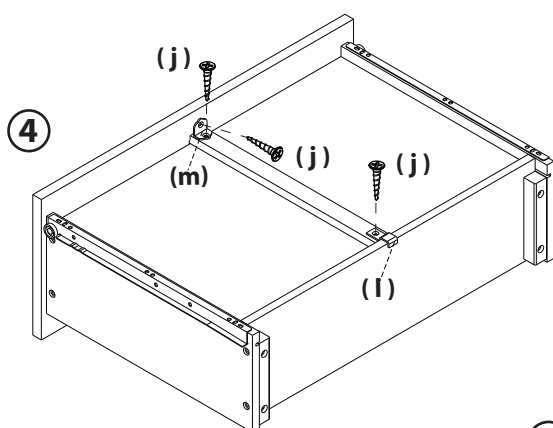
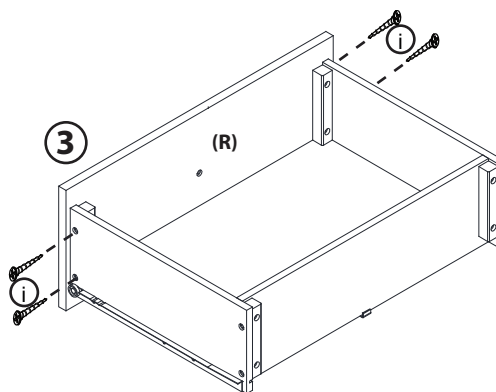

4. Attach Matel Connector A (m) and Matel Connector B (l). *Figure 4*

5. Using Drawer Knob Screw (g), install two (2) Knobs (k) on Drawer. *Figure 5.*

**Repeat for all drawers.
Set drawers aside for later use.**

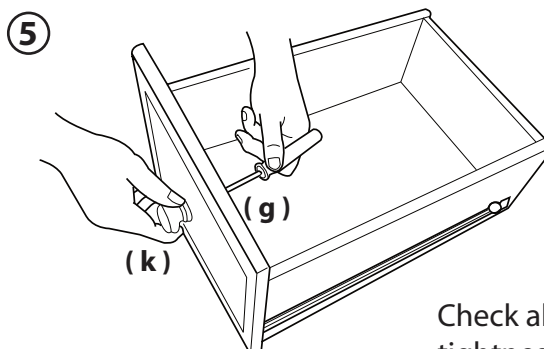

Check all screws for tightness.

Assembly Steps

- ⑥ Use 24 pcs Wood Screws (h) to attach the Back Panel (I) to the dresser
As shown in Figure 6..

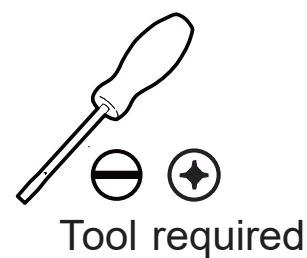
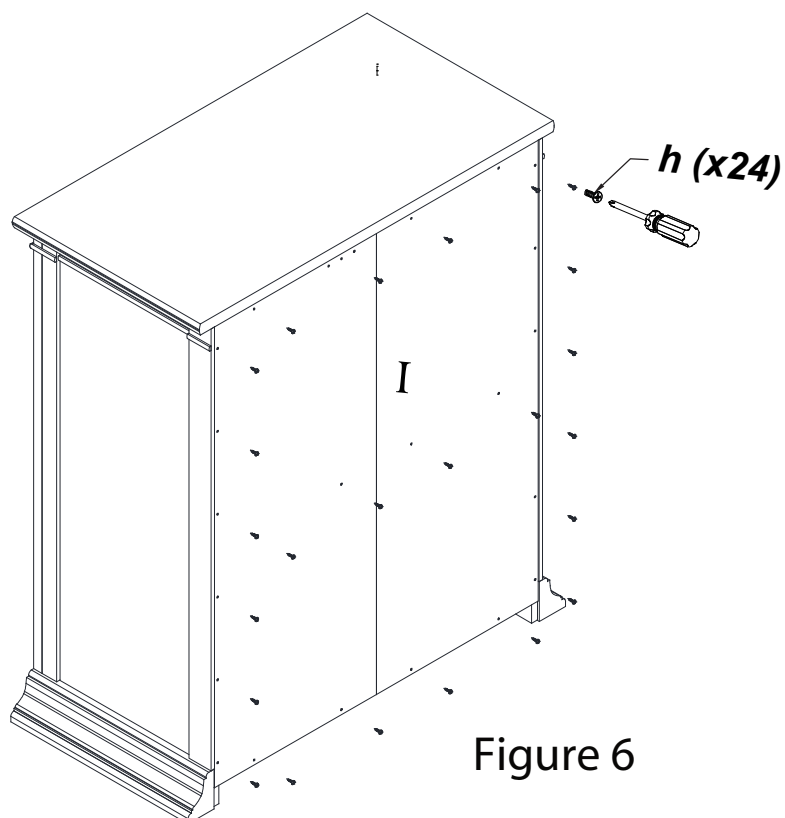

- ⑦ Assembly the drawer as Figure 7.

