



IMPORTED BY C&T International, Inc. / IMPORTE` PAR de C&T International, Inc.

105 Stonehurst Ct Northvale, NJ 07647 U.S.A. Tel, 201- 531-1919 Fax, 201- 531-1920

CANADA ADDRESS:

3453, DU PRESIDENT KENNEDY LAC MEGANTIC, QUEBEC, CANADA G6B 2Y4

Website: www.sorellefurniture.com / Site Internet : www.sorellefurniture.com

Westley 4 Drawer Chest

Assembly Instruction



Important Information:

Read all instructions **BEFORE** assembling.
KEEP INSTRUCTIONS FOR FUTURE USE.



Assembly Parts

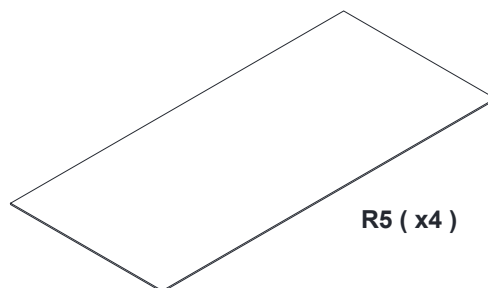
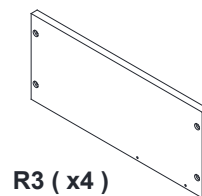
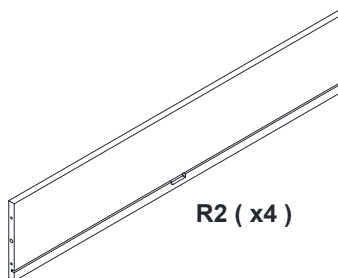
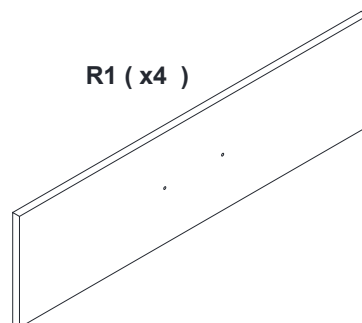
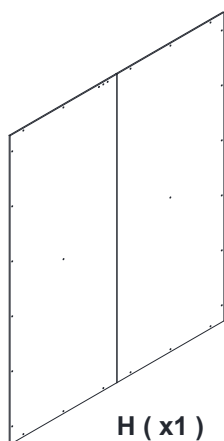
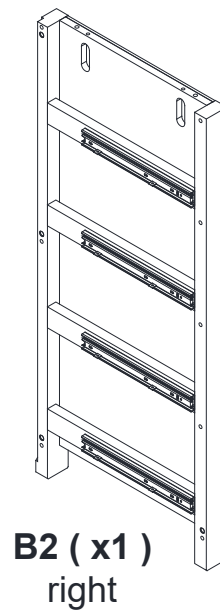
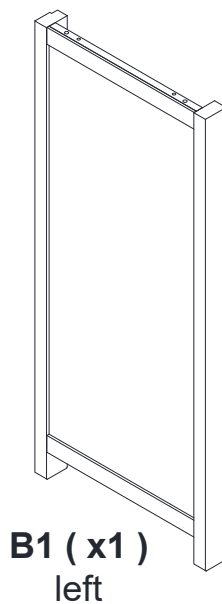
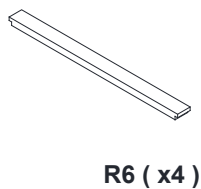
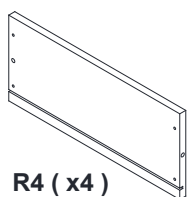
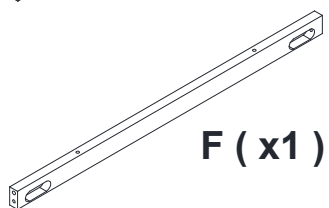
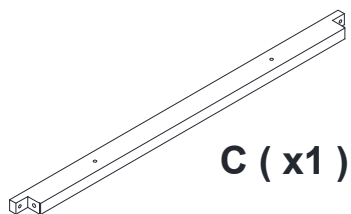
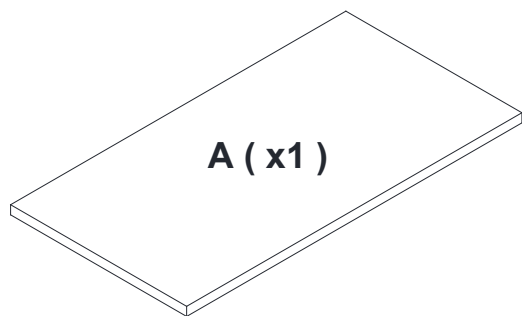

Hardware List

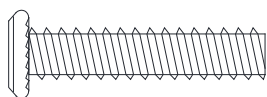
H1 (X10)

1/4"*32

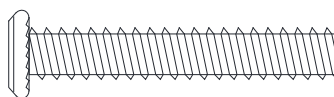
H2 (X14)

1/4"*42

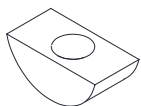
H3 (X12)

20*10*8

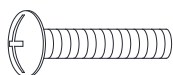
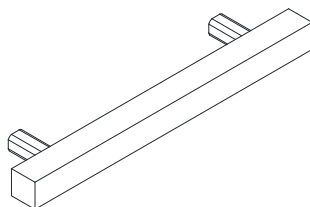

H4 (X12)
 Φ 12*6*1.2

H5 (X24)
 Φ 11*6*1.5

H6 (X16)
 Φ 9.5x9.5

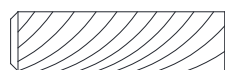
H7 (X8)
 Φ 5/32*19

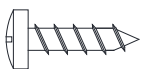
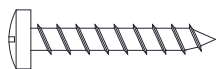
H8 (X4)

177*15*37

H9 (X20)
 Φ 8*30

H10 (X16)
 Φ 6*30

H11 (X26)
 Φ 8*15

H12 (X16)
 Φ 8*25

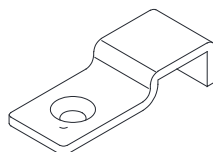
H13 (X16)
 Φ 8*45

H14 (X16)
 Φ 6*12

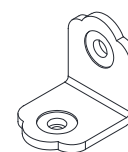
H15 (X12)
 Φ 7*12

H16 (X4)

40*15*2

H17 (X4)

20*18*16

H18 (X1)

M4x110

Important : 1. Please do not use power tool

Veuillez ne pas utiliser d'outil électrique

2. Please do not over tighten the bolt/ screw

Veuillez ne pas trop serrer les boulons et/ou les vis

3. Please clean the product use water, do not use liquid/ detergent.

Veuillez nettoyer le produit avec de l'eau, ne pas utiliser de détergent liquide.

4. Please set up the anti-tip kit

Veuillez configurer et installer la courroie anti-basculement.

Westley Chifferobe Assembly Steps

1

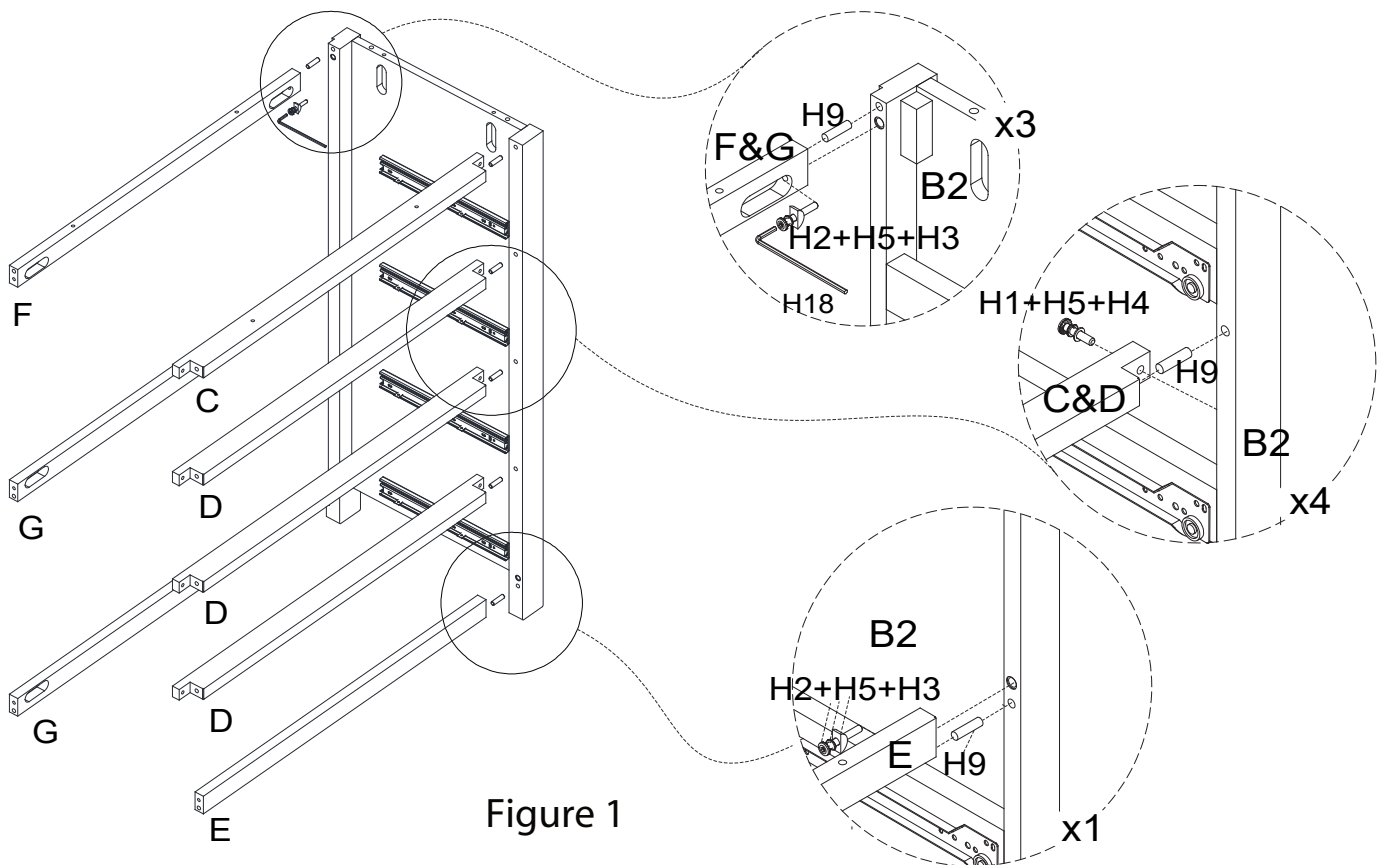

2

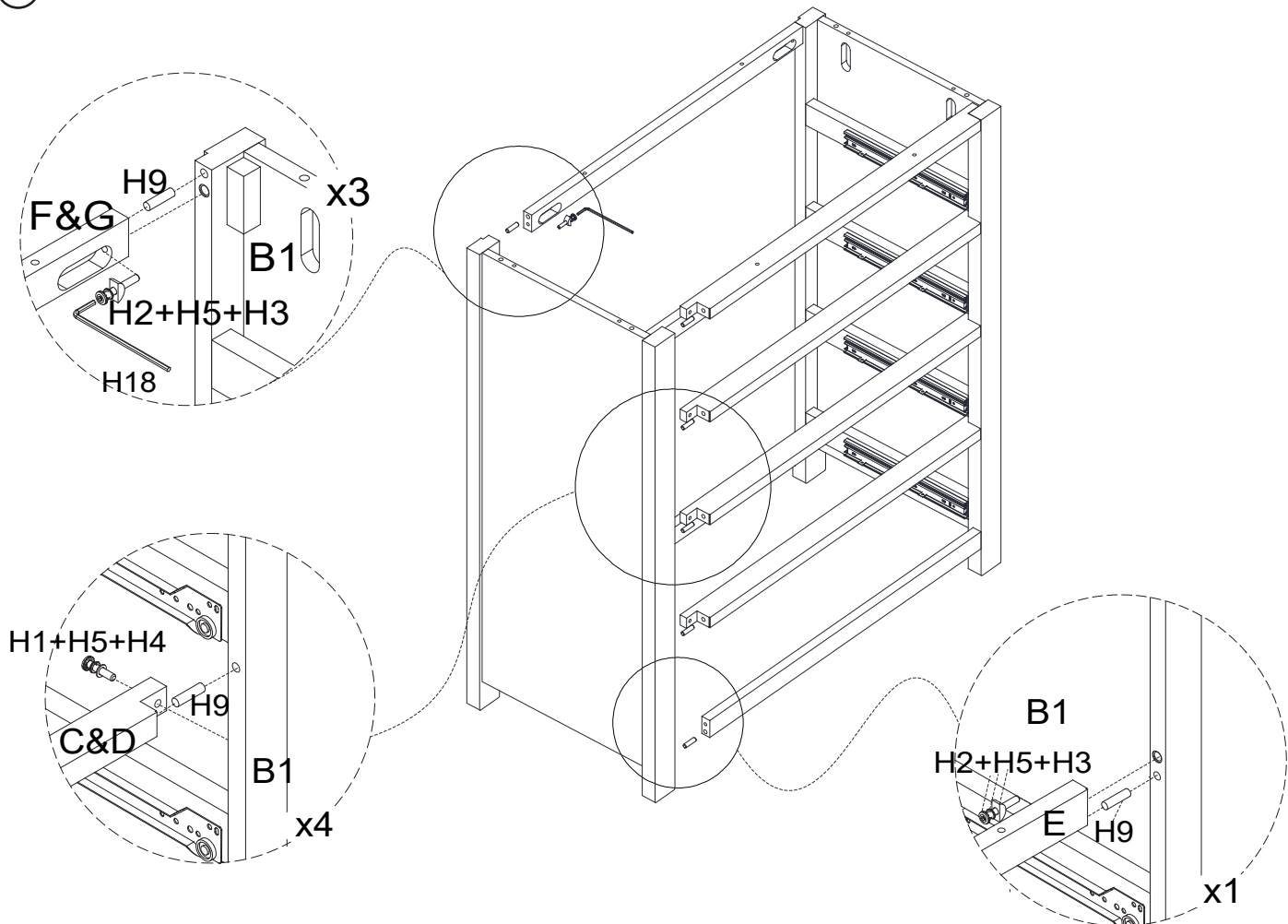

Westley Chifferobe Assembly Steps

3

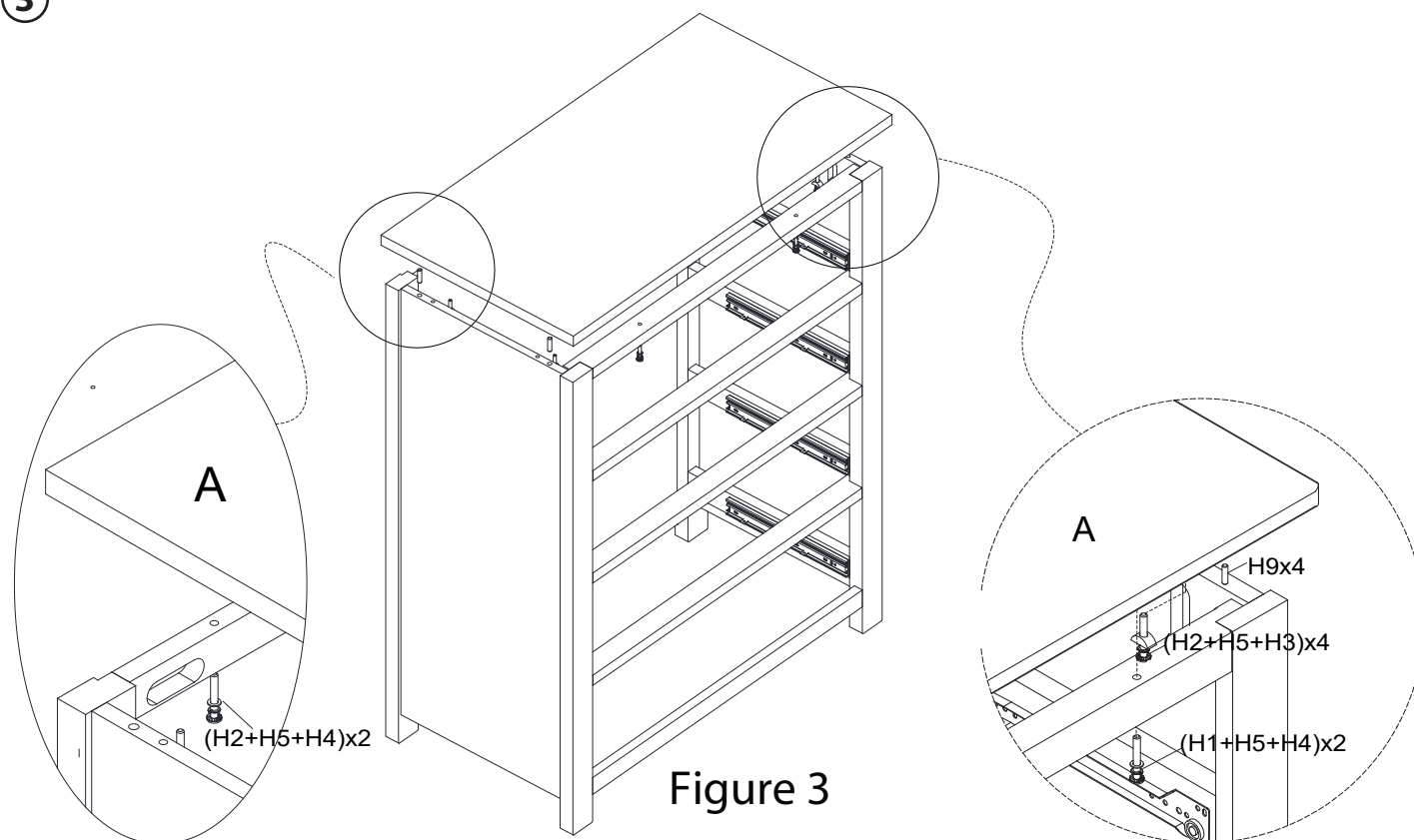

4

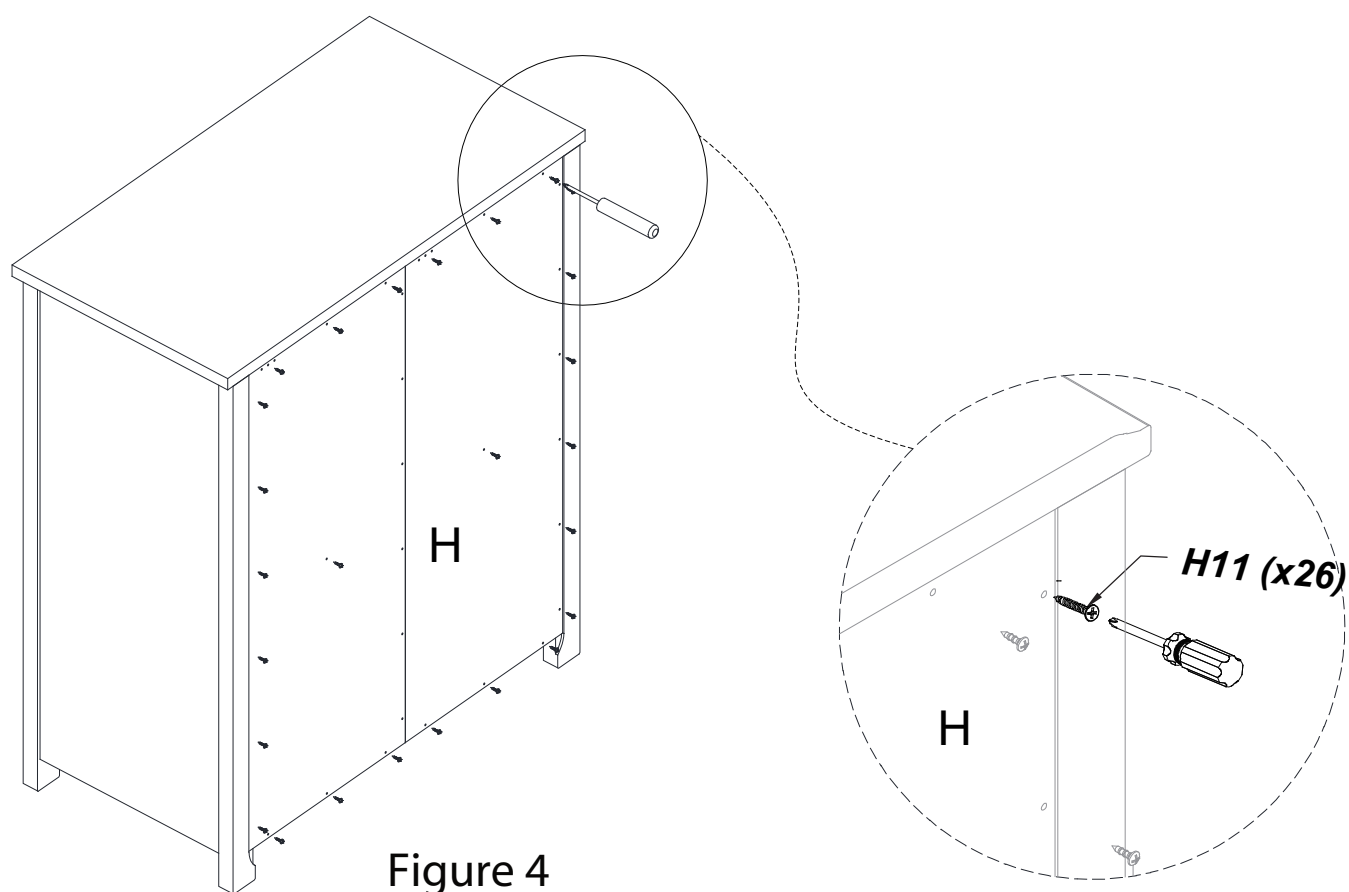

Drawer Assembly Steps

1. Working on a padded flat surface, attach Drawer Sides (R3&R4) to Drawer Back (R2) as Figure1

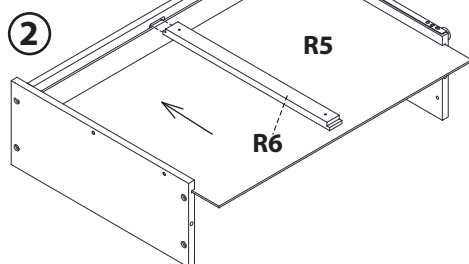
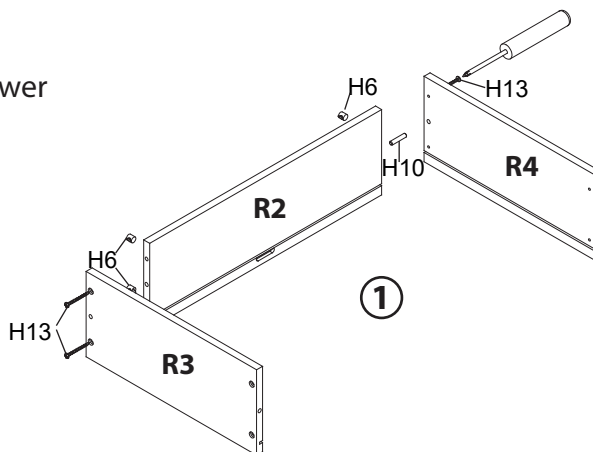

2. Slide Drawer Bottom (R5) and into drawer Bottom Support (R6) assembly as Figure 2.

3. Secure both sides of Drawer Front (R1) to drawer assembly as Figure3.

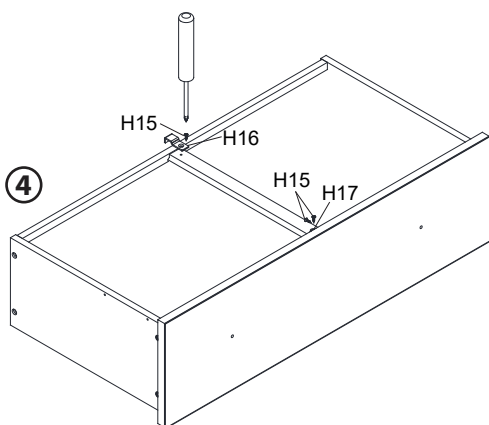
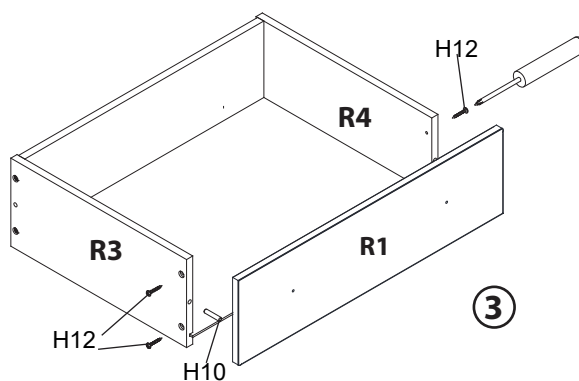

4. Attach Metal Connector A (H16) and Metal Connector B (H17). Figure 4

5. Using Drawer Knob Screw (H7) install Knob (H8) on Drawer as Figure5.

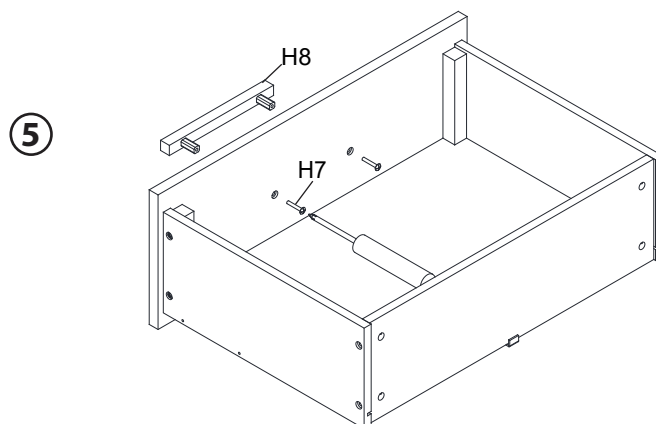

Repeat for all drawers. Set drawers aside for later use.

Check all screws for tightness

Assembly Steps

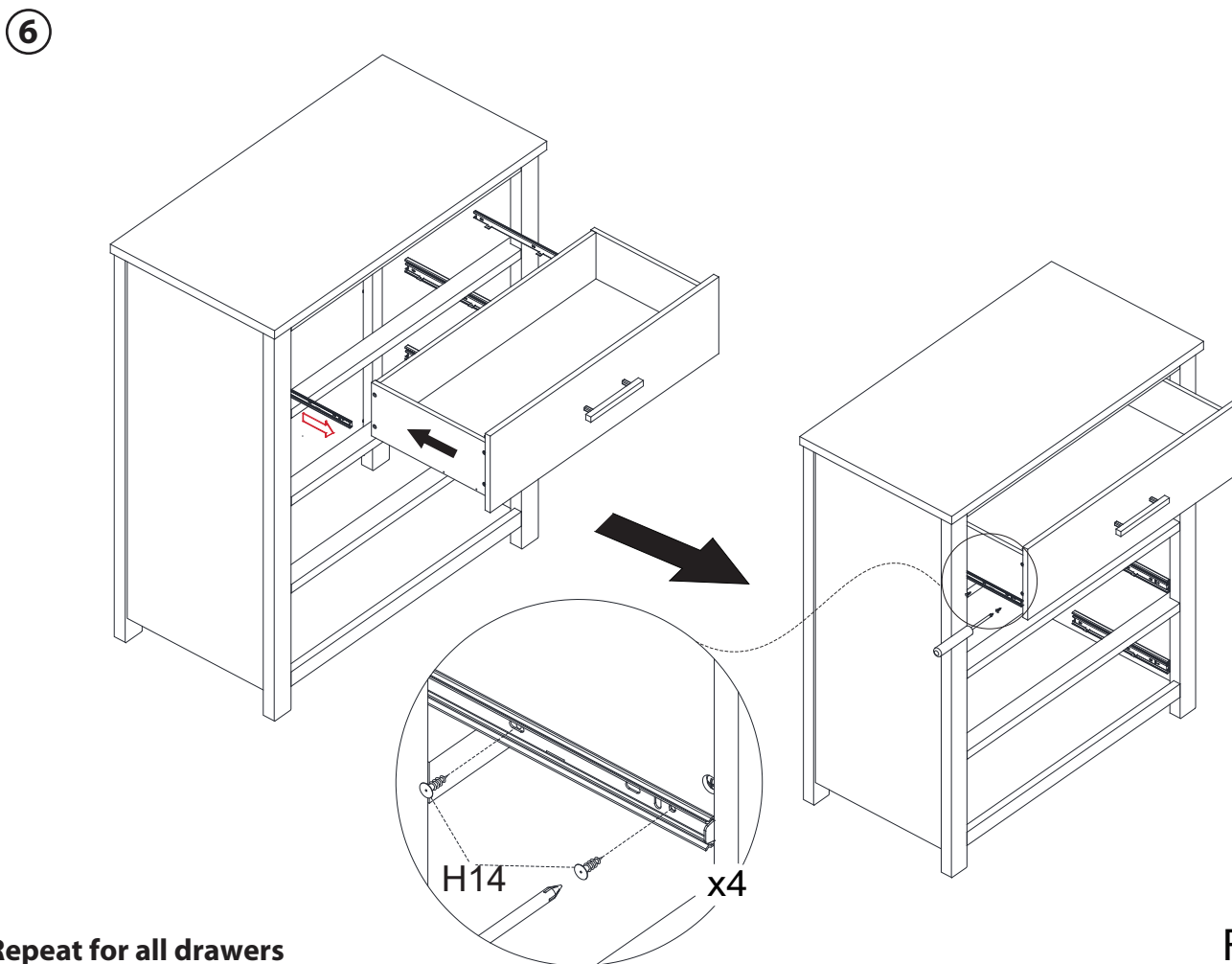

Repeat for all drawers

Figure 6

NOTES ON ASSEMBLY:

-During the assembly process whenever using screws or bolts, check each by placing the screw/bolt on the diagram of the item which is drawn actual size and design. Be sure to use the proper size and shape specified in the instructions.

-To assemble this unit you may be required to place the unit on it's side and face. It is strongly recommended that assembly is done on a soft, non-abrasive surface to avoid damaging the finish.

NOTES ON USE:

Keep children and others safe by following these simple rules:

- **Do not** allow any child to play on furniture
- **Do not** allow climbing on any piece of furniture.
- **Do not** allow hanging from any piece of furniture.
- Always monitor your child's activity when in the nursery.

NOTES ON CARE AND MAINTENANCE:

- **Do not** scratch or chip the finish.
- Inspect the product periodically, contact C&T International Inc. for replacement parts or questions.
- **Do not** store the product or any parts in extreme temperatures and conditions such as a hot attic or a damp, cold basement. These extremes can cause a loss of structural integrity.
- To preserve the luster of the high quality finish on your product, it is recommended to place a doily or felt pad under any items you place on the finish.
- Clean with a damp cloth, then a dry cloth to preserve the original luster and beauty of this fine finish.
- Do not** use abrasive chemicals.
- Do not** spray cleaners directly onto furniture.
- Lift slightly when moving on carpeting to prevent leg breakage.
- Use of a vaporizer near furniture will cause wood to swell and finish to peel.